

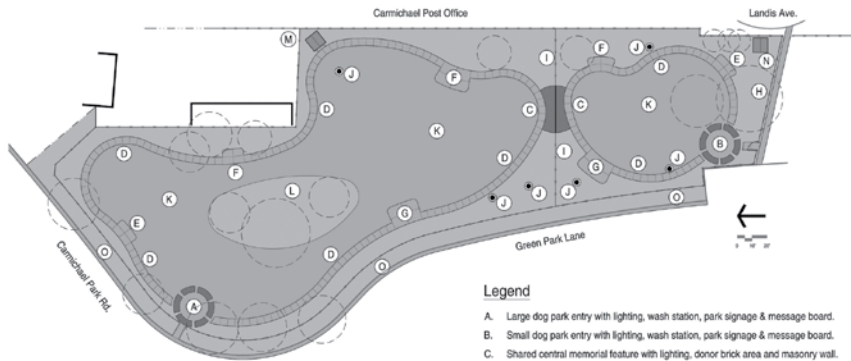

The Canine Corral Needs Your Help....



Carmichael Park Dog Park Master Plan

December 16, 2010



Legend

- A. Large dog park entry with lighting, wash station, park signage & message board.
- B. Small dog park entry with lighting, wash station, park signage & message board.
- C. Shared central memorial feature with lighting, donor brick area and masonry wall.
- D. 5' wide paved walkway, typ.
- E. Paved area with permanent seating.
- F. Paved area with permanent seating, shade structure and drinking fountain.
- G. Paved group social area with permanent seating, shade structure, drinking fountain and dog water feature.
- H. Existing fence at Landis Ave. entry to be relocated closer to entry walkway.
- I. New 6' high chain link fence with privacy slats separating large and small dog areas.
- J. Existing tree to be removed, typ.
- K. Open turf area, typ.
- L. Engineered wood fiber area, typ.
- M. Relocated storage shed.
- N. New small dog park storage shed.
- O. New 6' high chain link perimeter fence along Carmichael Park Rd. and Green Park Ln.

The Canine Corral has been in operation for approximately ten years and is in desperate need of renovation. It currently lacks a proper infrastructure, and poor drainage has caused standing pools of water resulting in illnesses to both pets and owners. It offers minimal shade, walkways and permanent seating. Throughout the winter, the Dog Park floods and is unusable. A Master Plan to renovate the Dog Park was approved by the Carmichael Park and Recreation District but now funds must be raised to make this project a reality.

Help support your local canine community by:

- **Purchasing a PERSONALIZED brick** that can be dedicated to a beloved pet, a favorite relative, a best friend, or anyone you would like to honor. Buying a brick will support the renovation of the Carmichael Dog Park and the bricks will be placed in a beautiful pathway on the ground at the park for all to see. Get an application for the bricks at www.CarmichaelDogPark.com.
- **Making a tax-deductible donation** to the Carmichael Canine Corral Dog Park to help pay for the renovation by sending a check made out to CRPD Foundation and mail to:

P. O. Box 1603, Carmichael, CA 95609
or by donating on our website.

Every little bit helps!!!

Dog Obedience

Taught by Lyle Reed

Does your dog need discipline? Help your pet better understand what you want by learning basic commands such as heel, sit, come, down, stay and many more. Dogs or puppies must be four months old and have all their DHLPP and Rabies shots. Proof of vaccinations MUST be presented on the first day of class. Please bring a 4 or 6 foot nylon or leather leash and a regular collar.

Location: Carmichael Park Vets
Hall Lawn

Day/Time: Saturday, 9-10am

Dates: 10/1-11/12 or 1/7-2/18

Fee: \$100/7 weeks

Canine Corral at CARMICHAEL PARK

A healthy dog is a happy dog! Get out and enjoy the weather with your pet. The Carmichael Recreation and Park District offers an off-leash dog park open to the public 7 days a week. It is located at Carmichael Park, 5750 Grant Avenue in the back of the park.

The Dog Park Society is made up of volunteers who help with the success of the dog park. There are many ways to help out and continue to provide a great place for pets. If you are interested in volunteering please call (916) 283-4919.

Photo Disclaimer



The Carmichael Recreation and Park District reserves the right to photograph facilities, activities, and program participants for potential future use in advertising brochures, web page or other District promotional purposes.